



# T600

OPERATING  
&  
FILTER REPLACEMENT  
DIRECTIONS

# TO BEGIN USING YOUR **AIRPURA**

**Inspect the exterior of your Airpura** to verify there is no damage from shipping. If any damage is noted, please follow the instructions from the distributor returns policy.

**Wipe the unit** with a damp cloth to remove any dust from packaging

**Plug the unit** into a regular grounded 110 volt outlet

**Turn on the unit** to MAX and allow it to run for a few minutes

**Set the variable speed** control to the level you wish

The most efficient way to use your Airpura for regular air quality maintenance is to run it at a low speed **24 hours a day 7 days a week.**

**Always maintain a humidity level of 35% or less in your home to ensure the unit is operating at optimal levels. Overly humid conditions can have an adverse effect on the performance of the carbon. When using purifier with a dehumidifier, please keep dehumidifier at least 6 feet away.**

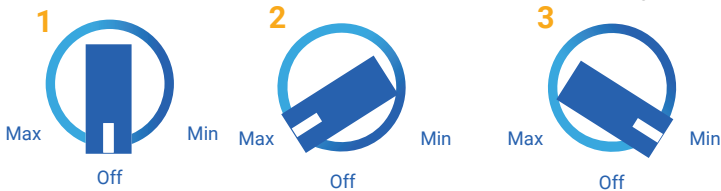

## **FILTER MAINTENANCE AND REPLACEMENT**

Ensure regular maintenance/replacement of filters

### **The Prefilter**

Can be vacuumed from the exterior of the unit once a month or more often. Should be replaced at least after 12 months of use

### **To vacuum the Prefilter**

Use the brush attachment on your vacuum cleaner  
Vacuum slowly around the mesh surface of the filter chamber



## **IMPORTANT SAFETY NOTE**

Please ensure air purifier is turned OFF when plugging into a power source. Failure to do so may result in motor potentially stalling and/or burning.



**TarBarrier Prefilter**

3-6 months

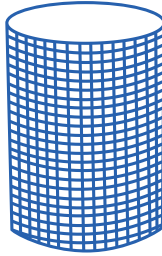

**HepaBarrier 600CT Filter**  
**(95% efficient @ 1 Microns)**

12-16 months

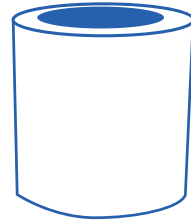

**26 lbs, Coconut Shell Carbon Filter (100% Blend), 3 inch**  
24 months

## Technical specifications

**Tobacco smoke odor, and chemical control**

26 lbs activated Carbon  
13"H x 13.25"OD x 7.5"ID

**Carbon bed**

3 in deep x 570 in<sup>2</sup> surface

**Tar removal**

Special TarBarrier filter  
570 in<sup>2</sup> x 1 in deep

**Particle supression**

HepaBarrier

**Air Flow 560 cfm**

More cfm than any other home unit available

**Housing**

Powder coat steel

**Size**

23 in x 15 in

**Weight**

49 lbs total

**Watts**

120 on high / 40 on low

**Sound Level**

28.1 db on low (at 6 feet)  
62.3 db on high (560 cfm)  
(Room level 25.1 db)

**ETL Certified**

Conforms to CSA C22.2  
no 113 ANSI / UL 507



## Air purifiers models and filter configurations

	Prefilter	Carbon
<b>Alternates</b>	Cotton Prefilter Poly Prefilter	26 lbs Anthracite Carbon Filter (100% Blend)
<b>Upgrade</b>		26 lbs Impregnated Carbon Filter (17% KI/ Potassium Iodide, 83% Coconut Shell Carbon) 26 lbs Impregnated Carbon Filter (35/65% Blend: KI/ Potassium Iodide, Coconut Shell Carbon)

## To open the filter chamber



**Turn over**  
the Airpura



**Remove** the 4  
retaining screws



**Take off**  
the cover



**Remove**  
the gasket



**Position** the  
Prefilter inside  
the filter  
chamber



**Place** a felt gasket at  
the bottom of the  
filter chamber



**Unfold** the filter slider  
(Supplied with replacement  
filters or on request  
Part#6F 001)



**Roll it**  
into a spiral



**Insert** the tube  
into the filter  
chamber inside  
the Prefilter



**Let** the spiral  
open to fill  
the opening

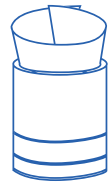

**Open** the top of the  
spiral to make a  
slight funnel



**Insert** the  
Carbon canister into  
the funnel and hold it  
straight



**Let** the canister  
slide down  
the filter slider

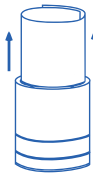

**Pull** the filter slider up  
out of the cavity using  
both hands and let the  
canister slide to the  
bottom of the cavity

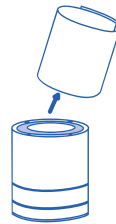

**Remove** the filter  
slider and fold it  
for further use

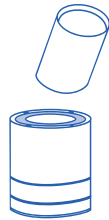

**Slide** in the  
Hepa filter

---

## To close the filter chamber



**Replace**  
the gasket



**Position** the  
indentation in the cover  
into the center of the  
HEPA filter



**Replace**  
the 4 screws  
and tighten



**Turn** the Airpura  
back on casters